

RCP Air Circulation Module

This module is designed to distribute the heat load within enclosed electrical panels by creating air-flow. Hot-spots are reduced within the panel, prolonging the life of electrical and electronic components.



Applications



The ACM is used for distributing the heat load within electrical panels whenever the electrical components are dissipating considerable amounts of heat and when the panels are installed in warm locations.

Alternatives

Use an enclosure with an external cooling package.

Features

- **Easy Installation** – Easy to install and retrofit into Argus panels.
- **Panel Integrity** - Maintains the environmental rating of the electrical panel as there are no additional enclosure cut-outs required
- **Adjustable** – On-board temperature setpoint controls.
- **Versatile Operation** – Options for control by the Argus System or as a stand-alone module.
- **Indicator Lights** – LED lights indicate operation status.

Specifications

Dimensions	Length: 7-1/2"; Width: 9-1/2"; Depth 1"
Fans	Dual Orion 24VDC 0.1A ball bearing fans
Mounting Bracket	Powder-coated aluminum
Circuit Protection	On-board circuit protection from a 1-1/4" x 1/4" 1A fuse (included)
Power Supply	24 Volts AC
Dimensions	Length: 7-1/2"; Width: 9-1/2"; Depth 1"

Wiring Details

Example wiring detail displaying optional external operation from an Argus controlled output. The fan is also capable of standalone operation. For installation always refer to wiring diagrams supplied with the part.

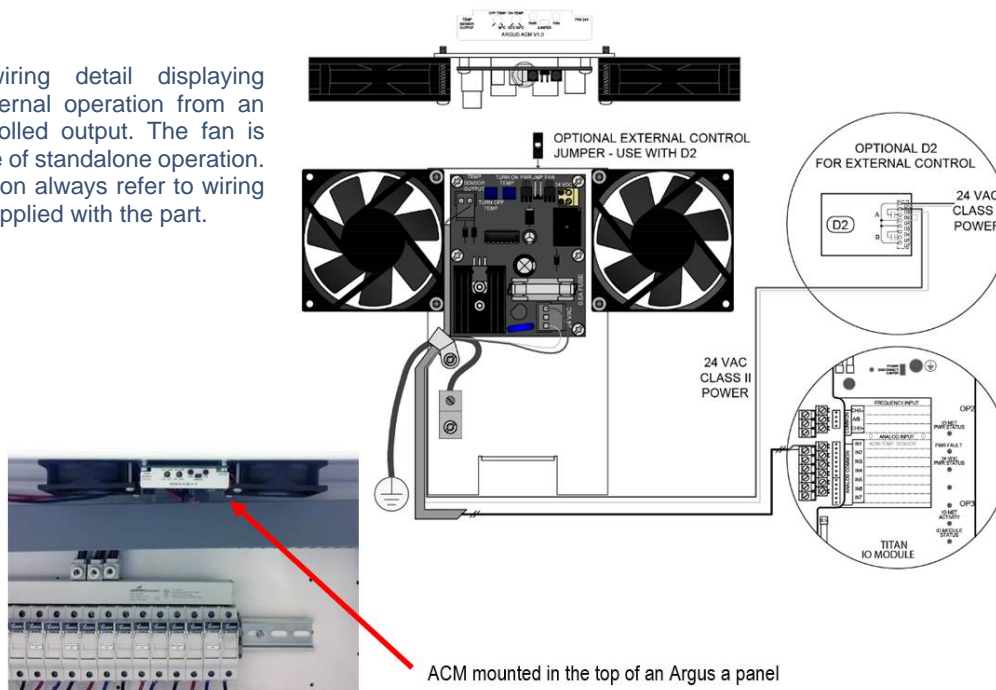

Additional Information

For more information, please contact Argus.

