

## USB Backup Module (Titan 2)

The Titan 2 USB Backup Module provides dual removable flash drives for storing control system backup data.



### Applications

The USB Backup Module is designed to work automatically with the Argus Backup/Restore Utility.



### Alternatives

This device is only used for backing up controller settings and other files needed for emergency restoration of an Argus system. Third party backup software can be used to back up all programs and files on the Argus Server PC.

### Features

- **Ease of Installation** – connects to the Argus Server PC using a standard USB cable.
- **Automatic Backups** – With the Backup/Restore option, automatic backups are performed at operator-defined frequencies.
- **Neat Drive and Cabling Configuration** – Storage drives and cabling connections are protected in a wall-mountable plastic enclosure with a removable lid. The enclosure is used to deter people from removing the USB drives for non-Argus use and ensure the device remains connected to the Argus Server PC at all times.

## Specifications

<b>Dimensions (Case)</b>	4.75" x 4.75" x 2½" (length x width x depth)
<b>Internal USB Hubs</b>	1 4-port bus-powered Hub.
<b>Removable Flash Memory</b>	2-8GB USB Flash drives are included.
<b>USB Cable Length</b>	5 Feet

**Caution:** Only connect to the PC using the **Backside USB Port**.

## Product Details

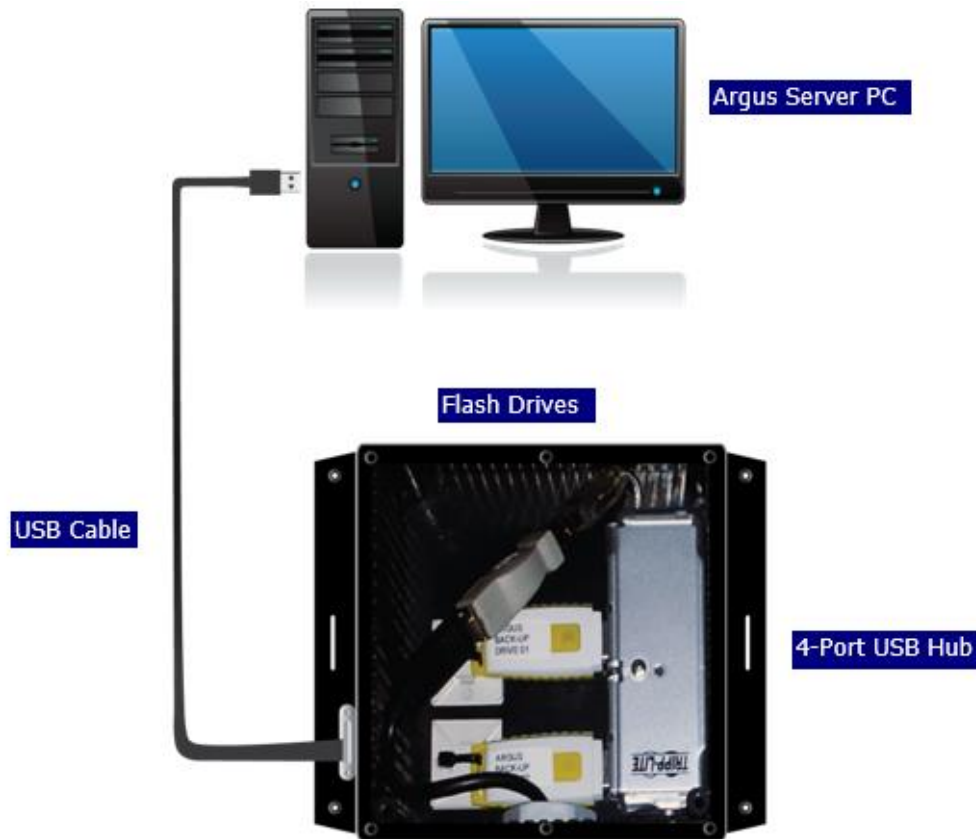

## Additional Information

For more information, please refer to the Omni-Sensor Operator Manual or contact Argus.

